

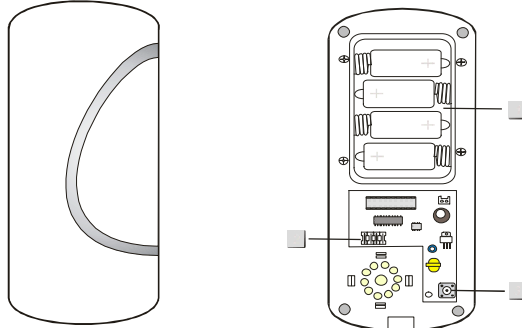

Wireless Indoor Siren (SR-7)



- **Battery Compartment** (with a lid secured with 4 screws)
- **Function Jumper Set**
Contains 4 jumpers to enable the learning mode and to set the alarm period of siren.
- **Tamper Switch**

Accessories included

In addition to the SR-7 itself, the following accessories are also included in the package:

- a. 4 x D-cell Alkaline Batteries to be placed in ■
- b. 4 x 6mm dowels.
- c. 4 x screws to be placed in four corners

Jumper Position Table

You can see a jumper set which consists of 4 jumpers marked as J1 ~ J4 from left to right. The function of each jumper is stated as tabled below.

| | | |
|---------|---------|------------------|
| JP1 | | Mode |
| Linked | | Normal operation |
| Removed | | Learning mode |
| JP2 | JP3 | Alarm Period |
| Linked | Linked | 3 min. |
| Removed | Linked | 5 min. |
| Linked | Removed | 90 sec. |
| Removed | Removed | 1 second (test) |
| JP4 | | Memory Reset |
| Linked | | Normal |
| Removed | | Clear Memory |

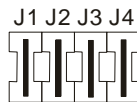

The jumpers are either On or Off. On is when the jumper connects two pins, Off when it is removed. To prevent the jumper from being lost when removed, it can be “**parked**” on one pin as show:



The jumper is in OFF / parked / Removed position.



The jumper is in ON / linked position.

SR-7 Function Overview

- **Siren Memory Clear**

The siren can be reset and the memory contents cleared by removing the batteries, waiting 1 minute, removing the link across the jumper JP4 and re-inserting the batteries. The siren will produce a short confirmation tone. The link should then be re-inserted otherwise the siren code learning will be reset every time the siren has a power-up sequence.

- **Siren Audible Performance**

- The siren produces a minimum of 104 dBA sound pressure at 1 meter on axis.
- The siren duration is programmable via placing two jumpers (JP2 & JP3) in four different combinations (please refer to the above table):
 - 1) 3 min.
 - 2) 5 min.
 - 3) 90 sec.
 - 4) 1 second (test)
- The fourth position (1 second) is used for testing during installation process.
- The siren is silenced when either the siren duration expires or the control panel turns off the siren.

- **Tamper Alarm**

The siren is protected from its top lid removal. If the siren detects a tamper condition, it will activate the siren for the programmed period. If the tamper condition persists, the siren will sound a series of five pips every time the system is armed or when the tamper is enabled, to indicate a fault. Tamper feature can be enabled/disabled from the control unit by selecting the “**Device +/-**” menu then “**Program Siren**”, and choose from “**Siren Tamp. ON**” or “**Siren Tamp. OFF**” then press OK.

- **Confirm On, Confirm Off**

The siren can be programmed to produce additional confirmation beeps to tell you when the systems is armed and disarmed from outside the premises. One beep for armed or home armed, two beeps for disarmed.

The setting up procedure can be done from the control panel under “**Device +/-**” menu then “**Program Siren**” menu and select “**Confirm On**” or “**Confirm Off**”

- Disable the Siren Confirmation by selecting “**Confirmation Off**” and press “**OK**”.
- Enable the Siren Confirmation by selecting “**Confirmation On**” and press “**OK**”.

- **Entry Sound On, Entry Sound Off**

The SR-7 can be enabled or disable from sounding the Entry Delay warning beeps. The setting up procedure can be done from the control panel under “**Program Siren**” menu.

- Disable the Siren Entry Sound by selecting “**Entry Snd Off**” and press “**OK**”.
- Enable the Siren Entry Sound by selecting “**Entry Snd On**” and press “**OK**”.

- **Previous Alarm warning**

If there has been an alarm when you were away the siren will sound for 3 seconds when being disarmed.

WARNING: If the siren is activated for 3 seconds when you disarm your system there could be an intruder still in your premises.

- **Power Supply**

SR-7 features completely wire-free operation and uses four alkaline D cells. The battery-life is estimated at 3 years.

The SR-7 can detect if it's batteries are low. Low battery detection operates at a threshold of 4.4V +/- 10% where the SR-7 has enough power to typically operate for 1 month before complete exhaustion. The siren low battery signal will be enunciated by five beeps under Operation Mode.

Getting Started

To insert the batteries:

- Step 1. Release the screw at the bottom of SR-7 and pull the outer case out carefully.
- Step 2. The battery compartment is a large box in the SR-7 with a lid secured with 4 screws.
- Step 3. Remove the four screws as shown and take off the compartment lid.
- Step 4. Insert the D cell alkaline batteries provided into the battery compartment, taking care to put the batteries in the right way around.
- Step 5. The Siren will give a short confirmation tone when the last battery is inserted.
- Step 6. Replace the battery compartment lid with the four screws taking care not to over tighten

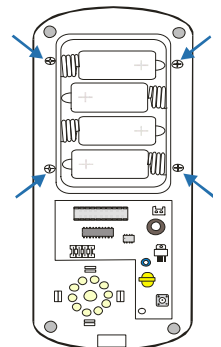

Programming SR-7

Note: Remember to learn in at least one other device into control panel before SR-7 can be added

- Step 1. Locate the jumper set.
- Step 2. Lift off jumper number # 1 and park it. The siren will give two short beeps to indicate it is now in the learn mode.
- Step 3. Program the control unit by selecting "**Device +/-**" menu, then "**Program Siren**" menu, then "**Learn Siren**".
- Step 4. Press OK and the control unit will give a long beep to confirm, followed by the siren's response of two short beeps. If the Siren has been already learnt-in, then, one short beep will performed to notify the user.
- Step 5. Replace jumper # 1 to the "**Linked**" position, the siren will give one short beep to confirm that the siren is now in Normal Operation mode.
- Step 6. Select "**Confirm ON**" or "**Confirm OFF**" under the "**Program Siren**" menu on the control unit, and press "**OK**". The siren will perform one short beep to notify the user.
- Step 7. Select "**Entry Sound ON**" or "**Entry Sound OFF**" under the "**Program Siren**" menu on the control unit, and press "**OK**". The siren will perform one short beep to notify the user.
- Step 8. Set jumper # 2 and # 3 (JP2 & JP3) for your desired alarm period.
- Step 9. The Learn-in process is now completed.

<NOTE>

- ☞ For Step 4, 6 and 7, please wait for 6 seconds after press the "OK" button each time.

Installing SR-7

- Step 1. Find the location where SR-7 is to be mounted
- Step 2. Using the 4 holes on the back of the base as shown as a template, mark off the hole positions.
- Step 3. Drill 4 holes and using the wall plugs and screws provided fix to a suitable wall.
- Step 4. Close the lid and tighten the lid fixing screw.
- Step 5. Enable Tamper switch by selecting "**Siren Tamp ON**" under the "**Program Siren**" menu on the control unit
- Step 6. Installation is now completed.

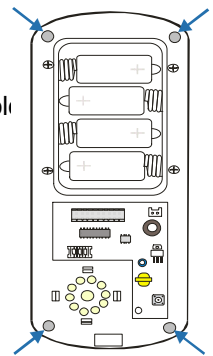

Changing the Batteries

Whenever a low battery enunciation arises and it is time for you to replace the batteries, remember to first disable the Tamper Protection from the Control Panel by selecting "**Device +/-**" menu, then "**Program Siren**" menu, then "**Siren Tamp. OFF**" and press OK.

After the batteries have been replaced, remember to enable the Tamper Switch again. Or the Disabled Tamper Switch will automatically revert to ON after about an hour if not switched back on again manually by selecting "**Siren Tamp. On**".

www.ezysecurity.com.au Toll Free 1800 241614